

HIGHWAY SECTION “DEMIR KAPIJA – SMOKVICA“

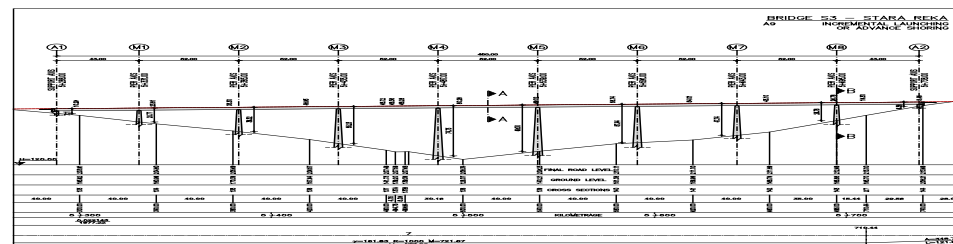
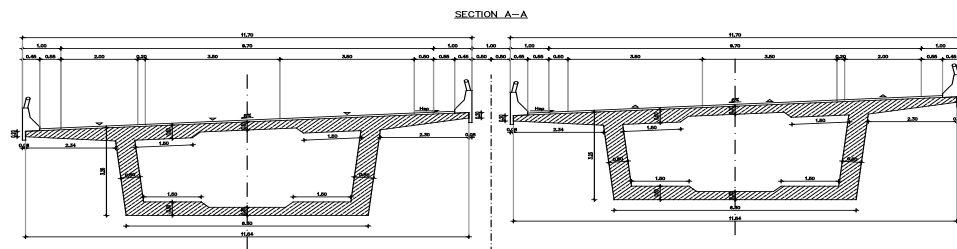
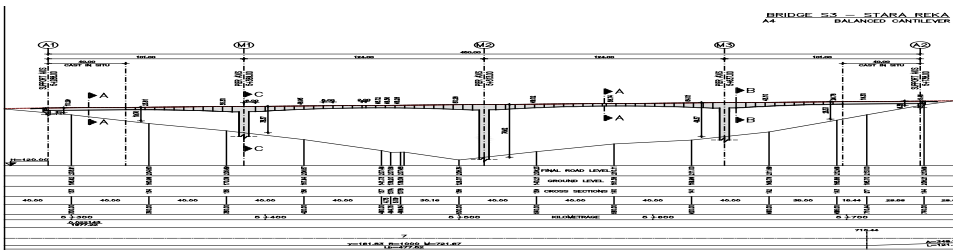
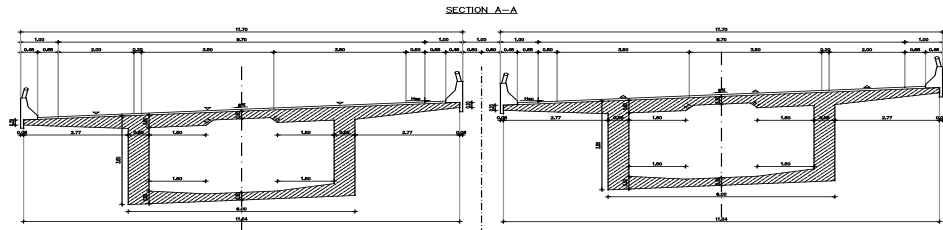

Highway design for the Demir Kapija - Smokvica section of European Corridor 10, as integral part of the national road M-1 (E-75)

Client

Agency of State Roads, FYROM

Project period

2009 – 2010 (Design)

Construction costs

51 M €

Services provided

Design services: conceptual, preliminary and final design of 2 Overpasses; final design for 3 Bridges

Technical details

Three Bridges: balanced cantilever prestressed concrete bridges, span length 65.00m-3x115.00m-65.00m (B3), 55.00m-3x95.00m-55.00m (B4), 70.00m-3x120.00m+70.00m (B5), total length 1 370.00 m.

Two Overpasses: Miravci OP (L=34.00 m) and Smokvica OP (L=91.00 m)